

LIVING & CO[®]

DEHUMIDIFIER



INSTRUCTION MANUAL

DYD-S10A412

AFTER SALES SUPPORT

 **NZ** 0800 422 274

Contents

	Page
Safety Instructions	3
Product Overview	5
Prior to Operation	7
Operation Instructions	8
Cleaning	11
Storage	12
Display Error Codes	12
Trouble Shooting	13
Technical Specifications	14

Safety Instructions

Warning

This appliance is intended for use in a domestic environment only. Any other use is not recommended by the manufacturer and may cause fire, electrical shocks or other person injury and property damage.



Cautions



Wet hands not allowed



Warning

Power Cord

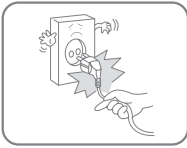

Hold the plug when unplugging the device from the socket. Do not pull on the cord.

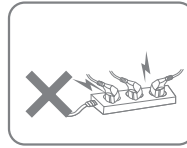

Ensure an extension cord or power board used in conjunction with this appliance is appropriately rated and in good working order.

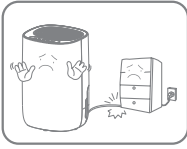

Do not put any heavy objects on the power cord in order to damage and electric shock risk.

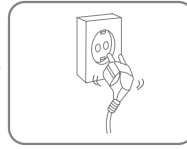

Do not use the appliance if the plug cannot be held in the socket firmly.



Do not attempt to change the power cord yourself. Contact an authorized service centre for repair.



Do not touch the plug with wet hands in order to avoid electric shock.

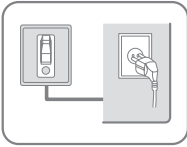

Only use a supply socket outlet that has a reliable earth connection.

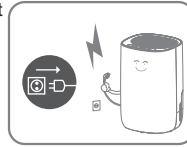

Please pull out the plug during lightning storms.

Safety Instructions

Placement



Do not put flammable and explosive objects around the appliance in order to avoid fire.

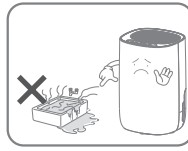

Do not use the appliance at a swimming pool or similar facilities in order to avoid safety hazard.

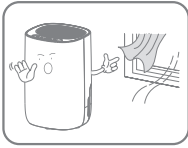

Do not use the appliance in a draughty place.



Place the appliance on a stable, flat surface.

During Use

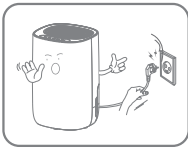

Please turn off the power and unplug the power cord before moving it.



Do not pour the water into the appliance in order to avoid malfunction.

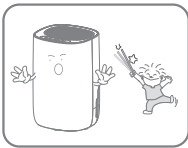

Children should be supervised to ensure that they do not place any objects into the appliance.



Do not put any heavy objects on the appliance in order to avoid malfunction.



Do not let the appliance topple over or let the appliance be subjected to strong impact in order to avoid malfunction.



The appliance must not be covered when being used.



Do not put hands on the air outlet in order to avoid injury or malfunction.

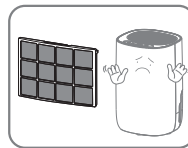

Please install the air filter before using it.

Product Overview

Figure1

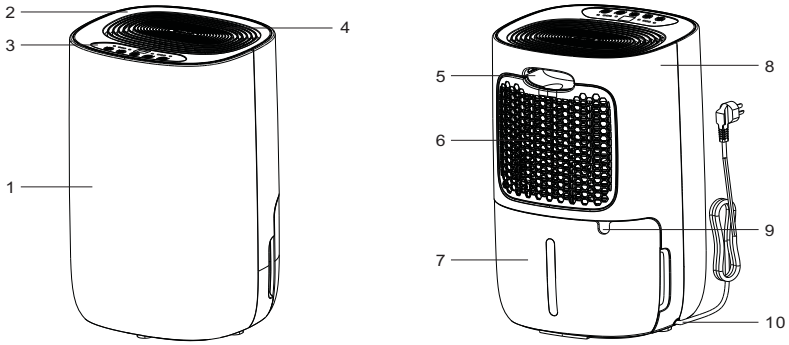

Figure2

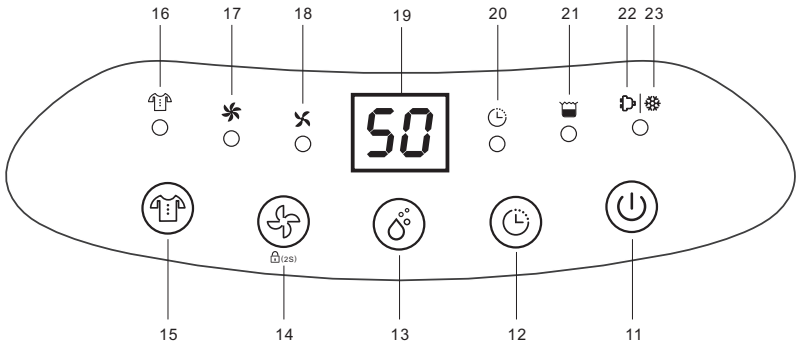
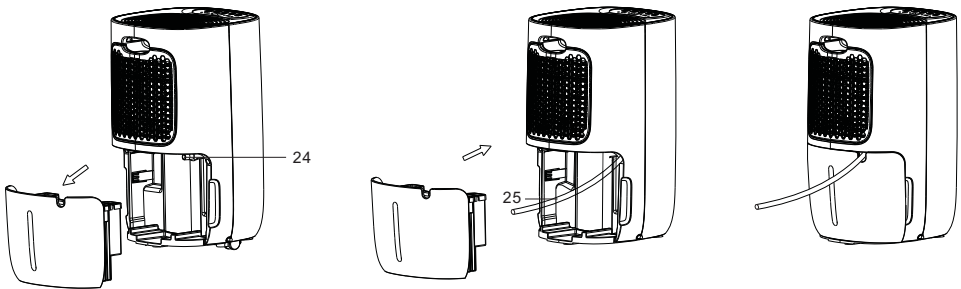

Figure3



Product Overview

Components

1. Front Cover
2. Top Cover
3. Control Panel
4. Air Outlet
5. Cupped lift
6. Air Inlet Filter
7. Water Tank
8. Rear Cover
9. Drainage Outlet
10. Power Cord

Control Panel

11. Power Button
12. Timer button
13. Humidity control button
14. Fan Speed Button/Child Lock Button
15. Laundry Drying Button
16. Laundry Drying Indicator
17. High Fan Speed Indicator
18. Low Fan Speed Indicator
19. Humidity Reading Display
20. Timer Indicator
21. Tank Full Indicator
22. Running Indicator
23. Defrost Indicator

Drainage

24. Drainage Outlet
25. Drainage Pipe

Prior to Operation

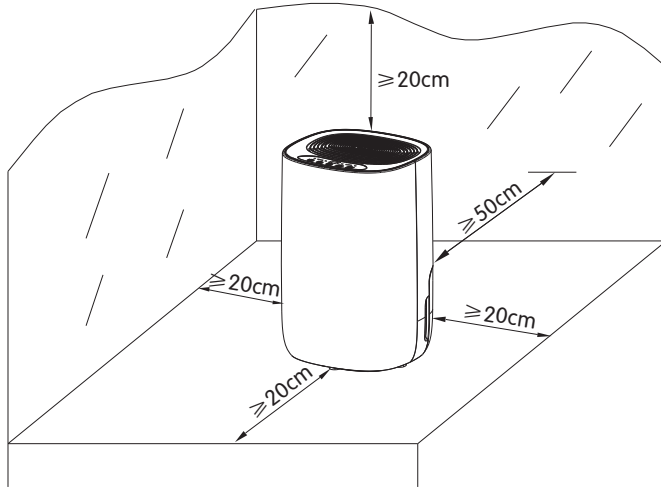

- Place the dehumidifier in an upright position on a stable, flat surface.
- Ensure the dehumidifier is at a safe distance at least 50cm away from a wall or furniture.
- Supply power should be in correspondence with the value on the nameplate, power outlet needs to be grounded.
- Ensure the tank is correctly fitted, if the tank is full or not in place, the tank full light comes on and the dehumidifier will stop working.
- Turn on the power.
- Select the relative humidity that you want, for most applications this will be 55%rh.
- Ensure that the air in/outlet is not blocked.

Continuous Drainage

In general, water will be collected by the integrated tank, if you want continuous drainage, please follow the steps in figure 3.

- a. Take out the water tank.
- b. Insert a drainage pipe with a 12mm inner diameter into the drainage outlet.
- c. Replace the water tank.

Note: always ensure the drainage pipe is going downhill, and is not blocked or kinked.

Operation Instructions

Switch On / Switch Off The Unit [Power button]



Connect to the power supply and press the power button once to turn on the unit, the unit runs by default mode on manual continuous dehumidifying with low fan speed.

- Press the power button to turn the unit off, the fan will continue to operate for a few seconds to blow out the hot air inside the unit.
- When the machine is in standby mode, the on/off indicator will flash slowly.

Auto Shut-off Timer Function [Timer button]

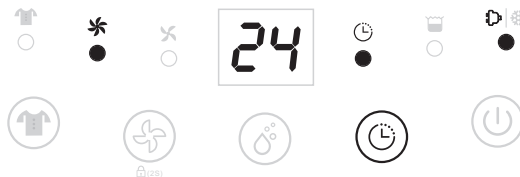

Press the timer button, then press up/down buttons to select your preferred number of hour from 00-24-00. The appliance will shut off automatically once the selected number of hours is reached.

- Auto timer function will be canceled if the timer button is pressed twice in 5 seconds.
- Auto timer function will be canceled if the appliance is switch off and on again.

Humidity Setting [Up and Down buttons]



Press the humidity setting buttons to select your preferred humidity from CO-30%-35%-40%-45%-50%-55%-60%-65%-70%-75%-80%-CO. CO means continuous dehumidifying regardless of ambient humidity.

Operation Instructions

Fan Speed Option [Fan Speed button]



Press the fan speed button to select your preferred fan speed setting of low and high to meet the different usage requirements.

⚠ Fan speed button is invalid at Laundry drying mode and Defrost mode.

Laundry Drying Function [Laundry Drying button]

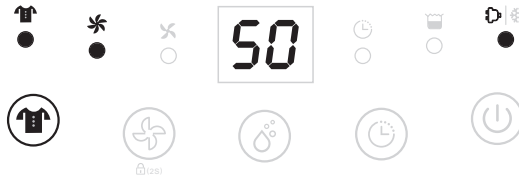

Press the laundry drying button to activate Laundry Drying function, the unit runs in continuous dehumidification with high fan speed for 6 hours then switch off automatically.

⚠ Fan speed button and timer button are invalid.

Safety Childlock Function [Fan Speed button-2 seconds]



Press the Fan speed button for 2s to lock all buttons with a beeping sound, the same operation can unlock it.

⚠ Safety childlock function can be set at standby mode and working mode but can't be activated when the water tank is full.

Operation Instructions

Low Temperature Defrost Indicator

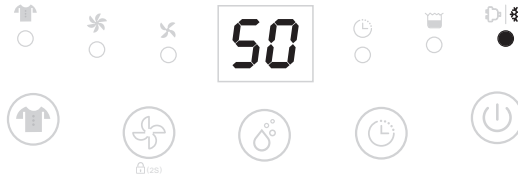

When the ambient temperature is too low, dehumidifier will enter into the defrost mode, the unit runs with high fan speed without dehumidifying.

Auto Shut off with Water Tank Full Indicator

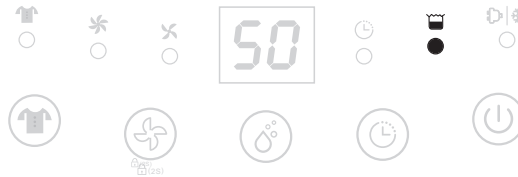

The unit will enter into standby mode when the water tank is full or the water tank is not installed properly. After emptying and re-installing the water tank, the unit will go on to the previous mode.

 Except for the power button, all other buttons are invalid.

Memory Function:

- When the unit is unplugged or after a power cut, the dehumidifier will run in the mode prior to the shutdown. The timer setting will be maintained.
- Press the power button to switch off the dehumidifier, and then press the power button to switch it back on. The dehumidifier will run in the mode prior to the shutdown. The timer setting will be canceled.
- Switch off the dehumidifier and unplug the power plug, then reconnect the power supply and switch on the dehumidifier. It will run in the factory preset mode like the first time you received the dehumidifier.

Cleaning

When used regularly, the filter may become clogged with dust and particles. Therefore the filter should be cleaned at least every two weeks. Follow these steps:

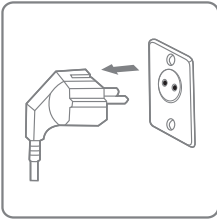

1. Switch the device off and remove the plug from the socket before cleaning.

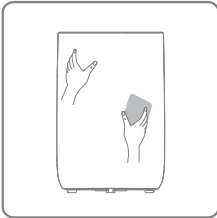

2. Clean the housing with a soft, dry cloth. If the device is extremely dirty, use a mild cleaning agent. Wipe the dehumidifier with a slightly damp cloth. Never spray the device with water.

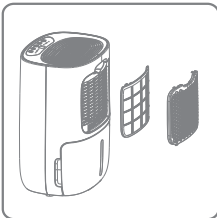

3. Remove the filter. Clean the filter with a vacuum cleaner or soapy water no hotter than 40°C.

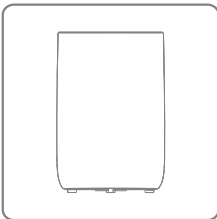

4. Rinse and dry the filter completely before installing back on the device.

Storage

If the dehumidifier will not be used for a long period of time, take the following steps:

1. Remove the plug from the socket and empty the tank, the tank and the dehumidifier to dry completely. This may take a couple of days.
2. Clean the air filter.
3. Check the dehumidifier for damage.
4. Pack the device with the suitable packaging.
5. Store the dehumidifier in a dust-free and out of direct sunlight location, preferably covered with a sheet of plastic.

Display Error Codes

Please contact local distributor if any of the error codes below appears.

Display Code	E1	E2
Error	Temperature sensor error	Humidity sensor error
Display	Flash every 30 seconds	Flash every 30 seconds
What is happening	Device still dehumidifies but is in defrost mode only.	Device still dehumidifies but is in continuous dehumidifying mode only.

Trouble Shooting

Check the following before contacting technical support .

PROBLEM	POSSIBLE CAUSE	SOLUTION
The device does not work	The power is not connected	Insert the plug into the wall outlet
	The water tank is full	Empty the tank
	The tank has not been replaced correctly	Replace the tank
Water removal capacity is too low	Runtime is too short	Be patient and leave the unit running for a longer duration
	Ambient temperature or humidity is too low	It is normal that the device does not dehumidify in these conditions
The device works, but reduces the relative humidity inadequately	The room is too big	We recommend using a dehumidifier with a greater capacity
	There is too much ventilation	Reduce ventilation(e.g. close windows and shut doors)
	The air filter is clogged	Clean the air filter
	Set humidity is higher than the ambient humidity	Set the humidity lower than ambient humidity
Dehumidifier is blowing out warm air	The dried air is passed over heating coils before it is blown into the room as part of the dehumidifying process	This is normal, a dehumidifier is not an air cooler
The display is not showing the humidity set point	The display shows the room relative humidity not the set point	Press the humidity control button once to see the target relative humidity
Water on floor	There is residual water in tank, and the device is lurched too much by moving	Be careful when moving the tank
The dehumidifier is noisy	The air filter is blocked or the device is on an uneven surface	Clean the filter or put the device on a flat surface

Technical Specifications

Model	DYD-S10A412
Power Supply	220-240V~ 50Hz
Dehumidifying Capacity	10L/day(30°C RH80%)
	5.0L/day(27°C RH60%)
Power Consumption	160W nominal / 225W maximum
Air flow	100m³/h
Water Tank Capacity	2.6L
Noise Level	40dB(A)
Operating Temperature	5~35°C
Refrigerant	R134a
Net Weight	10.5 kg
Product Size (W×D×H)	300 × 250 × 463 mm

The above technical data is indicative and for reference only. Some variation may exist between batches.

Compliance

This appliance has been fully tested and meets all requirements as set out by standards AS/NZS 60335.1 and AS/NZS 60335.2.40.



The RCM Mark(Regulatory Compliance Mark) indicates that the product complies with relevant guidelines of the ACMA as well as corresponding government requirements for the safety of electrical devices.

Responsible disposal

- At the end of its working life, make the appliance unserviceable by unplugging it from the power outlet and cutting the power cord.
- Do not throw this appliance out with your household rubbish. Electrical and electronic products contain substances which can have a detrimental effect on the environment and human health if disposal of inappropriately. Observe any local regulations regarding the disposal of electrical consumer goods and dispose of it appropriately for recycling. Contact your local authorities for advice on recycling facilities in your area.



LIVING & CO[®]

We pride ourselves on producing a range of quality home appliances that are both packed with features and completely reliable. We are so confident in our products, we back them up with a 3 year warranty. Now you too can relax knowing that you are covered.

Customer Helpline NZ:0800 422 274

This Product is covered by 3 year warranty when accompanied by proof of purchase.

IM Version 1.0 - Oct 2018